

SS-MB215

SERVICE MANUAL

AEP Model
UK Model



SPECIFICATIONS

Speaker system	3-way-3-speakers system, magnetically shielded
Loud speaker units	Woofer : 16 cm, cone type Mid range : 8 cm, cone type Tweeter : 1.3 cm, cone type
Enclosure type	Bass reflex
Rated impedance	8 Ω
Power handling capacity	Maximum input power : 120 W
Sensitivity level	87 dB (1 W, 1m)
Frequency range	60 Hz – 20,000 Hz
Dimensions (w/h/d)	Approx. 220 × 518 × 230 mm,
Mass	Approx. 6.5 kg per speaker, net Approx. 15 kg in shipping carton

Design and specifications are subject to change without notice.

SPEAKER SYSTEM

SONY[®]



EXPLODED VIEW AND PARTS LIST

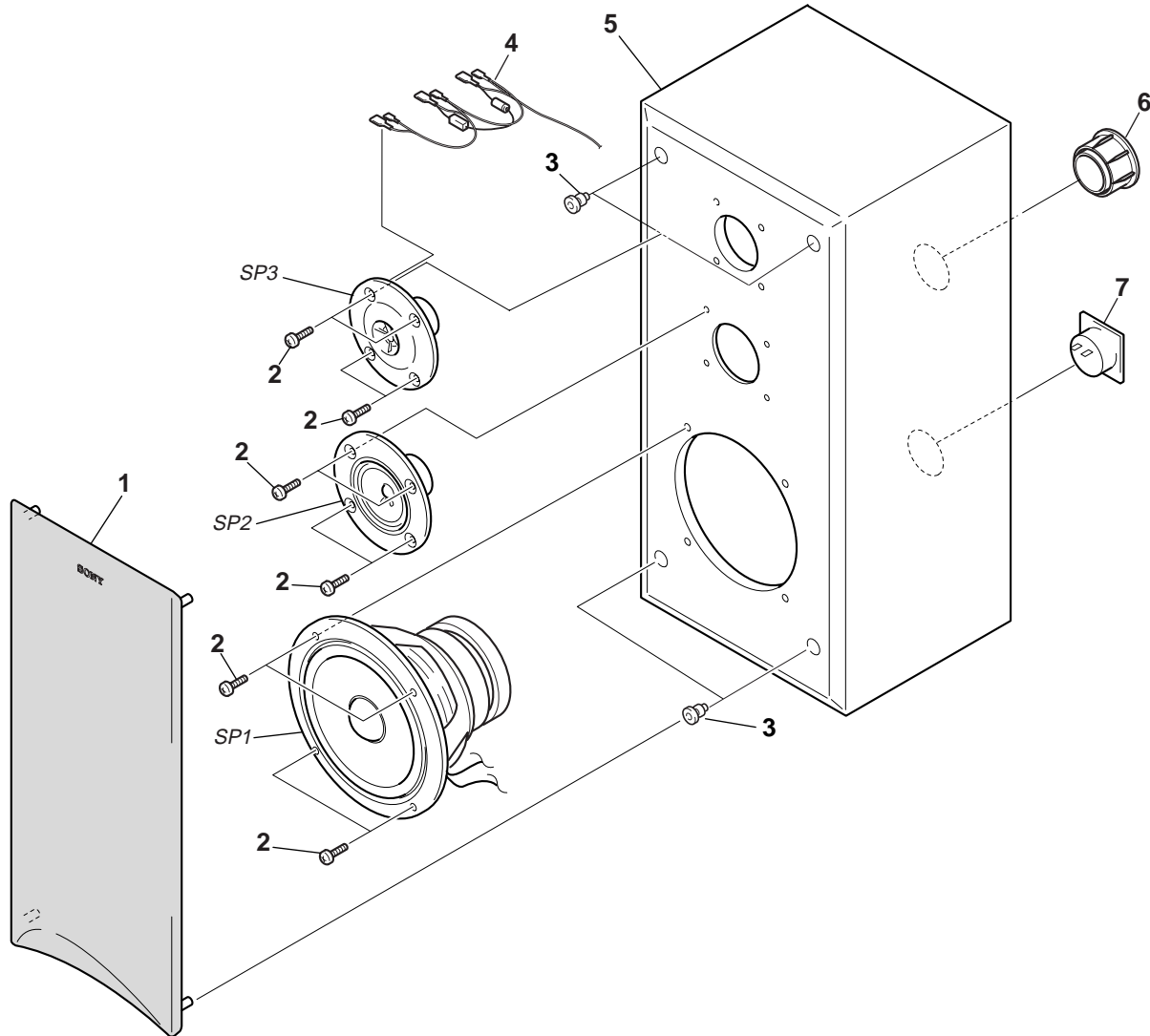

Ref. No.	Part No.	Description	Remarks	Ref. No.	Part No.	Description	Remarks
1	X-4951-234-1	FRAME ASSY, GRILLE				ACCESSORIES & PACKING MATERIALS	
2	4-222-556-01	SCREW +P 3.5 × 15				*****	
3	4-220-563-01	CATCHER					
4	1-790-625-11	INTERCONNECTING CORD					
5	4-217-525-01	CABINET, SPEAKER (BLACK)					
5	4-221-279-01	CABINET, SPEAKER (MAPLE)					
6	4-220-849-01	DUCT					
7	1-527-529-11	TERMINAL BOARD					
SP1	1-529-326-11	SPEAKER (16 cm) (WOOFER)					
SP2	1-529-275-11	SPEAKER (8 cm) (MID RANGE)					
SP3	1-529-256-11	SPEAKER (1.3 cm) (TWEETER)					
						1-751-495-1	CORD, SPEAKER
						3-866-060-11	MANUAL, INSTRUCTION (ENGLISH, FRENCH, SPANISH, PORTUGUESE, GERMAN, DUTCH, ITALIAN, SWEDISH, DANISH, FINNISH, RUSSIAN, POLISH, CZECH, HUNGARIAN)